

- Industrial
- Commercial
- Office
- Land
- Business

## FOR LEASE

### Office Condo 390 or 2,575 SF

Prime turn key office space on Randall Rd. Corridor and minutes from I-90. Elevator building.

**Suite 202** is a 390 SF private office suite, move-in ready.

**Suite 300** is 2,575 SF (1,845 SF usable). Multiple glass partitioned private offices, conference room, and kitchenette. Loft feel with suspended balconies connected to the suite. See photos and layout.



LoopNet: 19777168

MLS: 09223720

PROPERTY SPECIFICATIONS	
Description:	Office space
Building Size:	15,818 SF
Land Size:	.93 acres, Lot 5
Year Built:	2007
HVAC System:	Gas forced air/Central air
Electric:	200 amp
Sprinklered:	Yes
Washrooms:	Varies per floor, 2 minimum
Floors:	Concrete
Ceiling Height:	Varies per floor
Possession:	Immediate
Parking:	Per code with cross parking
Sewer: Village	Water: Village
Zoning:	B-2 PUD
Real Estate Taxes:	\$3.39 psf (2016)
CAM:	\$3.60 psf
Lease Term:	Varies
Lease Price:	<b>202</b> - \$23.00 psf full-service Gross <b>300</b> - \$13.00 psf NNN

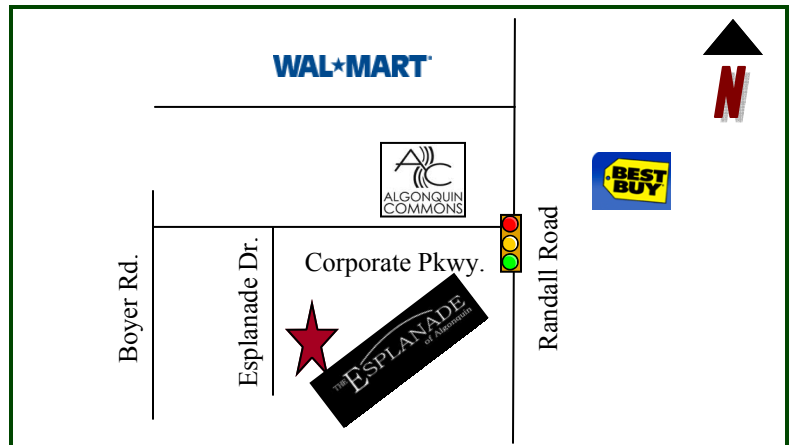

**Directions:** I-90 to Randall Road exit, north 4.5 miles, west on Corporate Parkway, south of Esplanade Drive. Site is south of Algonquin Commons.

**PIN:** 03-06-426-012

May 18, 2017

No warranty or representation is made as to the accuracy of the foregoing information. Terms of sale or lease and availability are subject to change or withdrawal without notice. This document is for information purposes only. No offer of sub-agency is being made.

- Industrial
- Commercial
- Office
- Land
- Business

2380 Esplanade Dr.  
Suite 202  
Algonquin, IL 60102

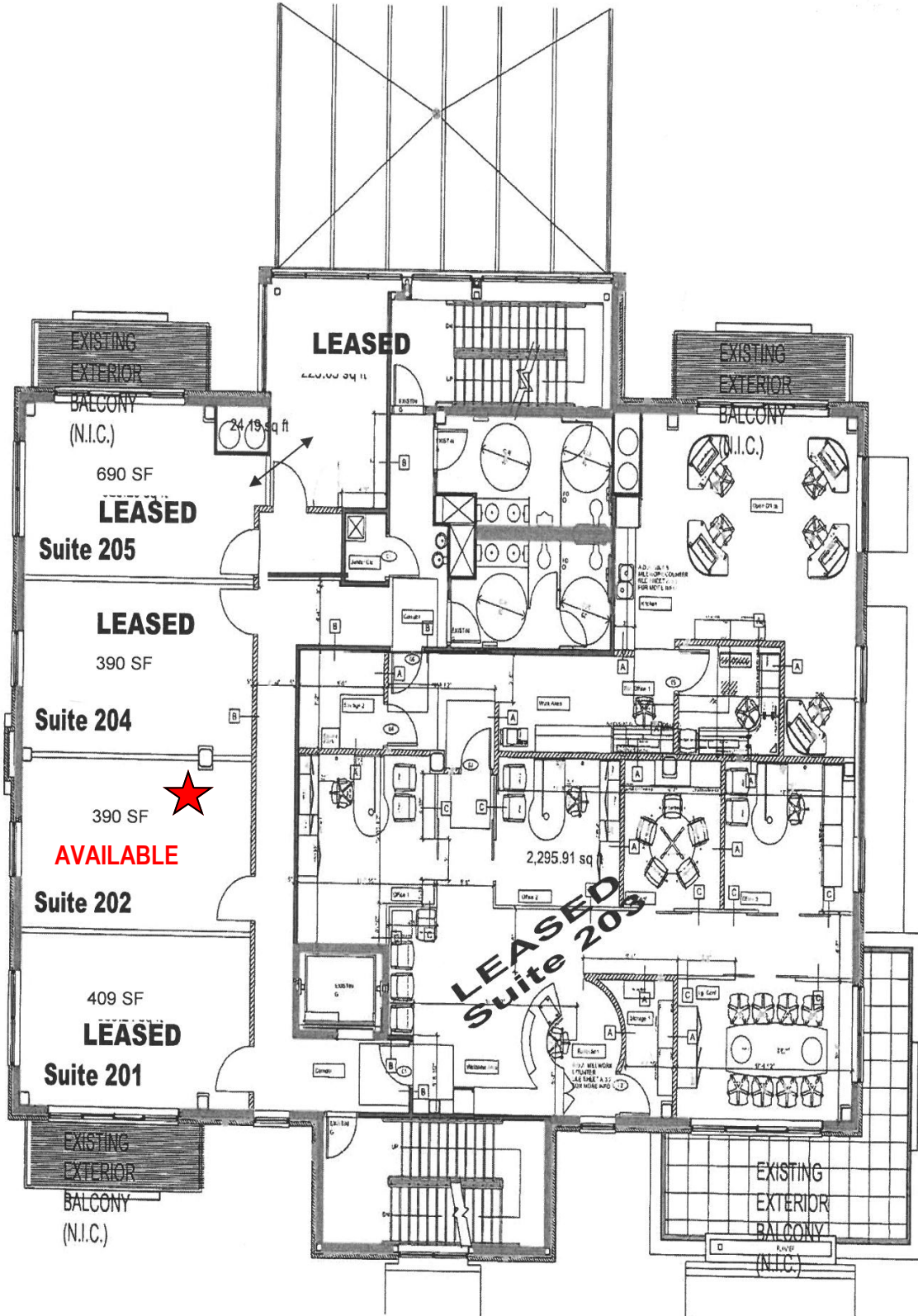

- Industrial
- Commercial
- Office
- Land
- Business

2380 Esplanade Dr.  
Suite 300  
Algonquin, IL 60102

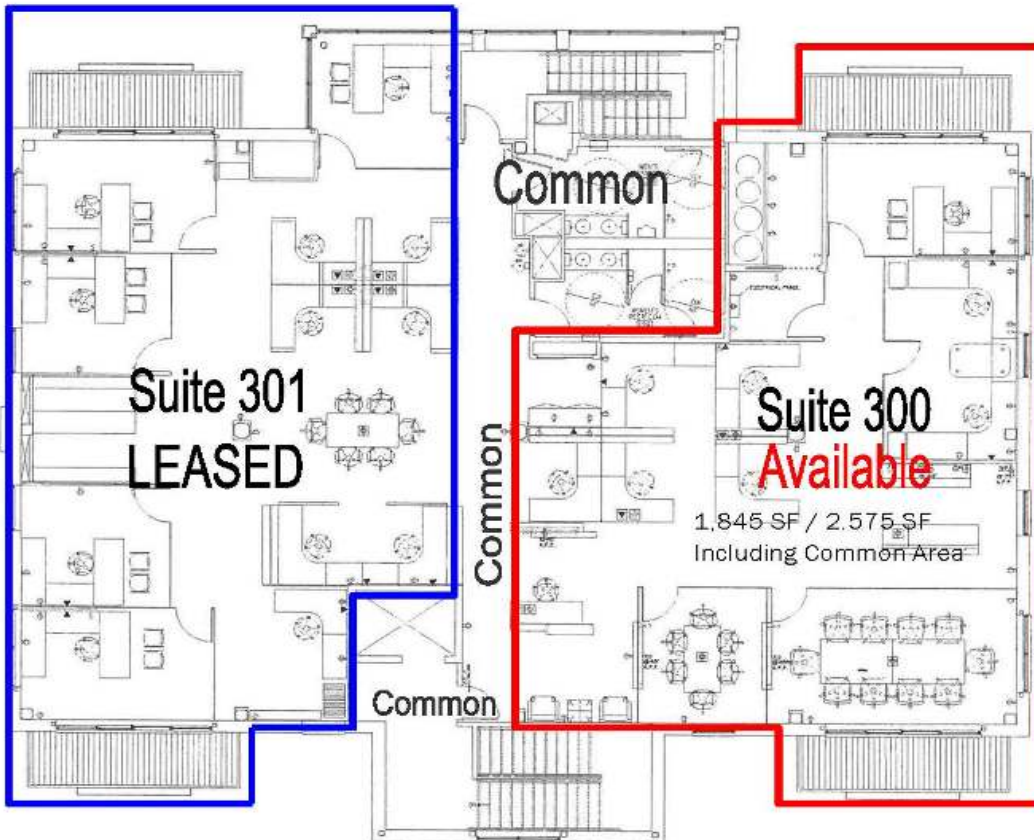

- Industrial
- Commercial
- Office
- Land

2380 Esplanade Dr.  
Suites 202 and 300  
Algonquin, IL 60102

